

BD-066 Ofuton Warm Adapter

Thank you for purchasing a Snow Peak product. This product is a liner for camping sleeping bags (bedding). For safety, read the following instruction manual before use. Please keep it safe for future reference. Finally, if you find anything that you do not understand in the description or any problems with the product, please stop use immediately and contact the retailer or Snow Peak Customer Service.

Contents

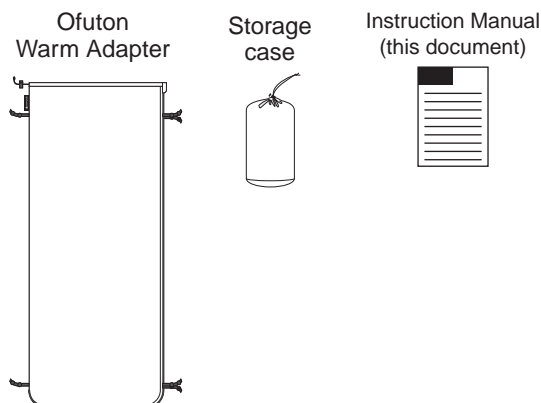

Specifications

Material: Polyester
Size: 75x180cm / 29.5"x70.9"
Storage Size: 16x25cm / dia.6.3"x9.8"
Weight: 800g / 28.2oz

Safety Precautions: Before use, please read thoroughly to ensure safety and avoid accidents.

⚠ DANGER / Misuse could easily result in a serious accident or death.

Keep fire away: This product is not fire-retardant. Do not use or leave this product near a combustion-based lantern, stove, heater, or other heat source. Do not smoke while in this product.

Do not use this product for any purpose other than its intended use. Doing so may result in unexpected accidents or injuries.

⚠ WARNING / Misuse could result in serious injury or death.

Before using the product, check each part for abnormalities. If there are abnormalities, take the product to the dealer or Snow Peak Customer Service for inspection or repair.

⚠ CAUTION / Misuse could result in injury to the user and/or damage to property.

This product is designed to be used as a liner inside a camping sleeping bag (bedding). This product alone does not provide sufficient insulation. Avoid using it by itself outdoors or in cold environments. Do not pull with excessive force or expose the product to sharp objects. Doing so may cause damage. Storing the product while wet, exposed to high humidity, and with dirt still on it may cause mold to develop. Clean and dry thoroughly before storing.

Color may transfer to other items due to exposure to water, sweat, or moisture. Please handle with appropriate care. Static electricity may occur in dry seasons or environments. Please take extra care when using this product with synthetic sleeping bags or clothing.

Instructions for Use

[Instructions for Use]

This product can be attached to the inside of the comforter cover of the System Ofuton and Slim Mat / Wide Mat (BD-061/DB-071) and the Down System Ofuton and Slim Mat / Wide Mat (BD-060/DB-070). Insert the snap-button tape of this product through the loop located inside the System Ofuton, and fasten the snap button to secure it. (4 locations)

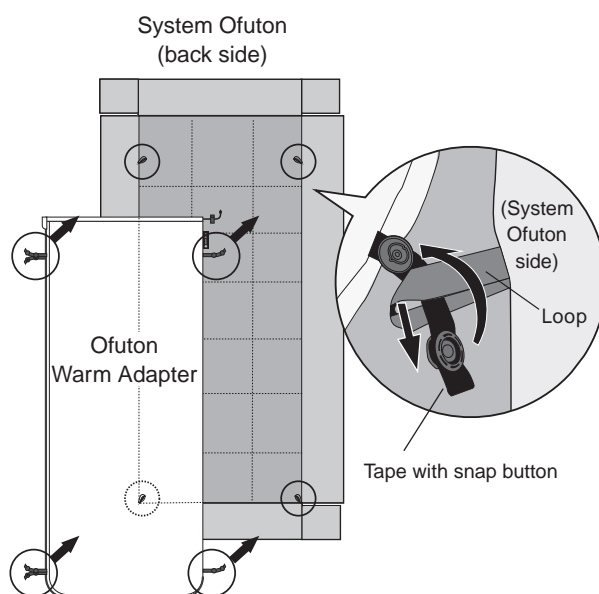

[How to store]

Close all the zippers on this product and lay it flat. Fold it to a width that fits into the storage case, then roll it up. Tighten the drawstring.

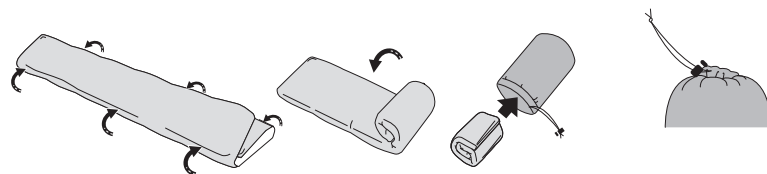

[Handling precautions]

This product is made from soft fleece material. However, due to the nature of the fabric, repeated use and washing may cause pilling. This is a natural characteristic of the material and not a quality defect. If pilling is a concern, do not pull it off forcefully. Instead, use a commercially available fabric shaver or pilling remover.

Maintenance

Before using a product that has been in storage for a long time, check each part for abnormalities. If there are abnormalities, take the product to the retailer or contact Snow Peak Customer Service for inspection or repair. Storing the product while wet or damp may cause mold, unpleasant odors, color transfer, or fabric deterioration. After use, dry it thoroughly in the shade, and store it in a well-ventilated area away from high temperatures, high humidity, and direct sunlight. Thoroughly maintain and inspect your equipment in preparation for your next camping trip.

[Washing precautions]

When washing this product, please follow the instructions below and carefully read the caution label attached to the product.

Use laundry detergent. Never use acidic or alkaline detergents. Always use a laundry net when washing this product. Do not wash with other laundry items, as the color may fade. It may shrink after washing.

Warranty

Snow Peak has taken all possible measures to ensure every product is durable and functions correctly. If you find any product defects, please contact the retailer where you purchased the product or Snow Peak Customer Service. If there are apparent defects in the product's manufacturing, the defective product will be repaired or exchanged free of charge. In other cases, Snow Peak will repair the product for an appropriate fee. The decision to repair or replace the product will be at our discretion. Snow Peak will not repair the product for any damage that occurred due to the following:

1. Material deterioration caused by age / 2. Damage caused by modifications or rough handling / 3. Damage caused by inappropriate use not mentioned in the instruction manual / 4. Damage caused by unexpected accidents / 5. Any damage other than defects in the manufacturing process / 6. Damage caused by dust or rust / 7. Damage and defects caused by dismantling the product / 8. Damage and defects caused by dropping, jolting or other shocks / 9. Deterioration or failure of parts due to friction / 10. Damage caused by the use of the product in combination with another manufacturer's products

Repair

If professional repairs are required, please contact the retailer where you purchased the product or Snow Peak Customer Service. When you request repairs, please make sure that the product is dry and clean. Please attach a memo or a tag indicating the necessary repair and please write details of how and when the damage occurred.

Transportation and repair costs are determined as follows. 1. Within warranty: The transportation cost (both ways) and repair cost will be covered by Snow Peak. / 2. Outside warranty: The transportation cost (both ways) and repair cost will be covered by the customer.

Snow Peak USA, Inc. 404 NW 23rd Avenue, Portland, Oregon 97210, USA
Tel. +1 (888) 424-4916 / Instagram. @snowpeakusa
Email. info@snowpeak.mom / www.snowpeak.mom

Snow Peak, Inc. 456, Nakanohara, Sanjo-Shi, Niigata 955-0147 Japan
Tel. +81 256-46-5858 / Fax. +81 256-46-5860
www.snowpeak.co.jp

MADE IN CHINA